

4.0 Specifications

Description	Inch Units	Metric Units
Cutting Width	30 ½"	77.5 cm
Clamp Opening	4"	10.2 cm
Clamping Force	400-5000 lbs.	1.8 – 22 kN
Minimum Cut – Standard	¾"	1.9 cm
- Special	½"	1.3 cm
- w/ False Clamp Plate	2"	5.1 cm
Table Space		
Front: (std.)	25"	63.5 cm
Back:	30 ½"	77.5 cm
Dimensions		
Table Height	36 ½"	92.7 cm
Overall Height	58 ½"	148.6 cm
Overall Length	69 ½"	176.5 cm
Overall Width	48 ½"	123 cm
w/ Side Tables	78 ½"	200 cm
w/o Side Tables	48 ½"	123 cm
Approx. Net Weight	2550 lbs	1157 kg
Approx. Shipping Weight	2750 lbs	1247 kg
Will pass through door:		
Assembled	49"	125 cm
Table/treadle out	42"	112 cm
Table/treadle/pwr unit out	24-1/2"	63 cm
Electrical		
Standard: 5 HP, 3 Phase, 60 Hz AC; 208/230V, 25 Amps (Service size: 40 Amps) Optional Phase Converter Kit: K-3482 (1 Phase, 208/230V, Service size: 50 Amps)		
Optional: 5 HP, 3 Phase, 60 Hz AC; 460V, 11.5 Amps (Service size: 20 Amps)		
Optional: 5 HP, 3 Phase, 50 Hz AC; 380/415V, 10 Amps (Service size: 20 Amps)		

Electric Eyes –
 Response time = 68 ms
 Object detection capability = 12 mm

Challenge reserves the right to make changes to any product or specification without notice and without incurring responsibility to existing units.

5.0 Footprint

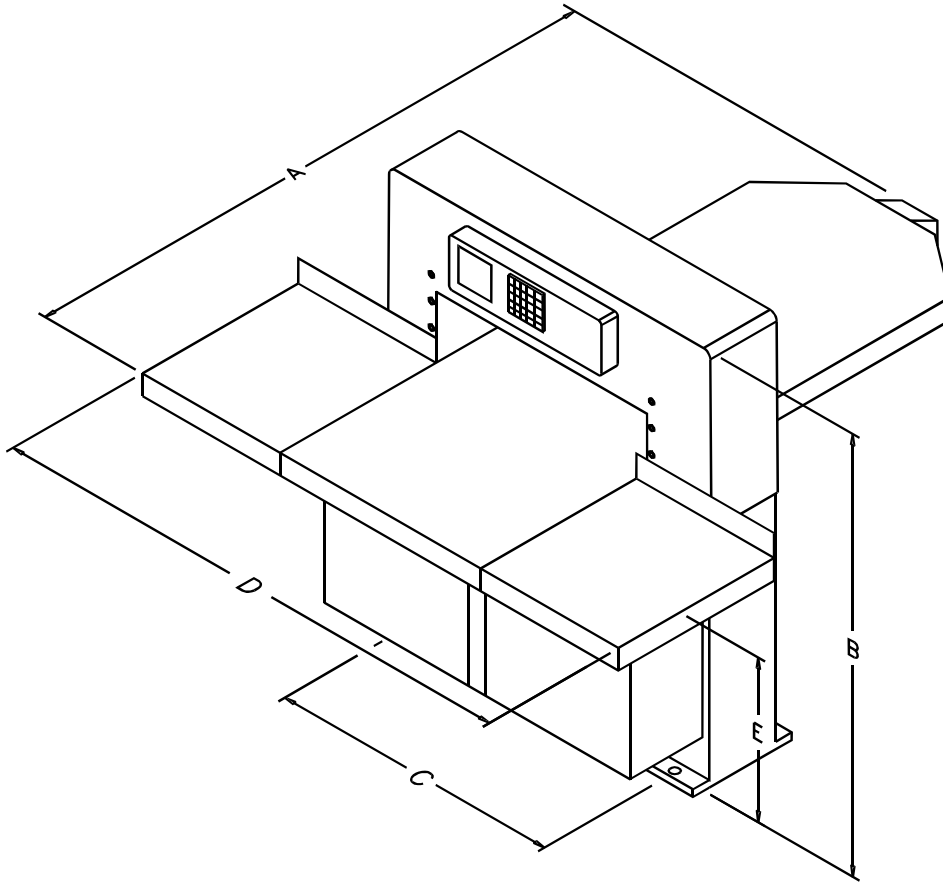

STANDARD SIDE TABLES

Symbol	Specification	CHAMPION 305		CHAMPION 370	
		Inch	cm	Inch	cm
A	Overall Length	69.5	176.5	86.25	219.1
B	Overall Height	58.5	149	60.0	152.4
C	Mounting-Front	41.5	105	60.25	153
D	Overall Width	78.5	200	109.0	276.9
E	Floor to Table	36.5	93	36.0	91.4
	Net Weight	2550lb	1159kg	3750lb	1701kg

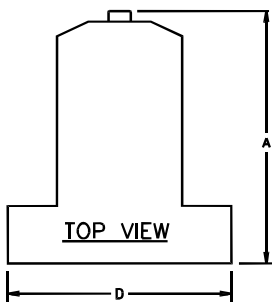

LARGE SIDE TABLES

Symbol	Specification	CHAMPION 305	
		Inch	cm
A	Overall Length	76.5	194.3
B	Overall Height	58.5	149
C	Mounting-Front	41.5	105
D	Overall Width	102.5	260.4
E	Floor to Table	36.5	93
	Net Weight	2600lb	1180kg

